

GTX5000-PRO

5.1 kWh

LV ENERGY STORAGE



Product advantages

- CATL battery cells, extensive cycle life (6000 cycles)
- User-friendly one-button operation, automatic module ID assignment process
- Supports parallel operation (up to 4 units)
- Wall- or floor-mounted installation, saving time and costs
- Remote diagnosis and real-time data monitoring
- Compatible with multiple hybrid inverter brands
- Efficient automated production line, achieving optimum production quality

Model		GTX 5000-PRO
System Parameters		
Battery type		LFP
Total energy		5120Wh
Usable energy		4600Wh
Rated voltage		51.2V
Operating voltage range		45.6V-56.16V
Rated charging/discharging power		2560W
Rated charging/discharging current		50A
Max. charging/discharging current		50A
Max. units in parallel		4
General Parameters		
Communication		CAN/RS485/RS232
Dimension (W*H*D)		480*606*171.5mm
Weight		47 kg
Protection rating		IP20
Cooling		Natural
Operating temperature		Charge: 0°C - +55°C / Discharge: -20°C - +60°C
Humidity		5%-95%
Installation		Wall-mounted / Floor stand
Max. operating altitude		2000 m
Standard		UN38.3, IEC62619, IEC62040-1, SAA, etc

*All specifications are subject to change without notice.
Note: Operating current derating according to cell voltage and battery

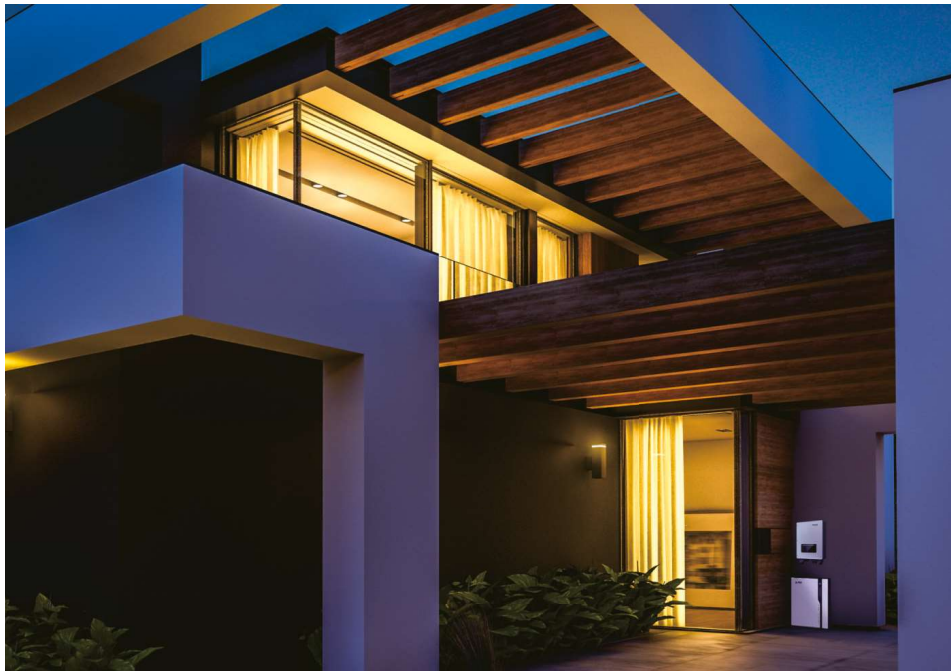

SOLUTION PV&ESS C&I

